



OFFICIAL PLAN of the TOWNSHIP OF CLEARVIEW

Schedule A12 - Old Sunnidale
Land Use and Transportation Plan
Secondary Urban Settlement Area

Official Plan Designation

-  Escarpment - Natural Area
-  Escarpment - Protected Area
-  Escarpment - Recreational Area
-  Escarpment - Rural Area
-  Agriculture
-  Rural
-  Residential
-  Estate Residential
-  Special Purpose - Residential
-  Commercial
-  Commercial Transition Area
-  Industrial
-  Extractive Industrial
-  Mineral Aggregate Resource Area
-  Mineral Resource Extraction Area(NEC)
-  Waste Disposal Industrial
-  Future Commercial
-  Future Development
-  Open Space
-  Greenland - Natural Heritage Areas
-  Greenland - Hazard Land Areas
-  Greenland - Wetland Areas

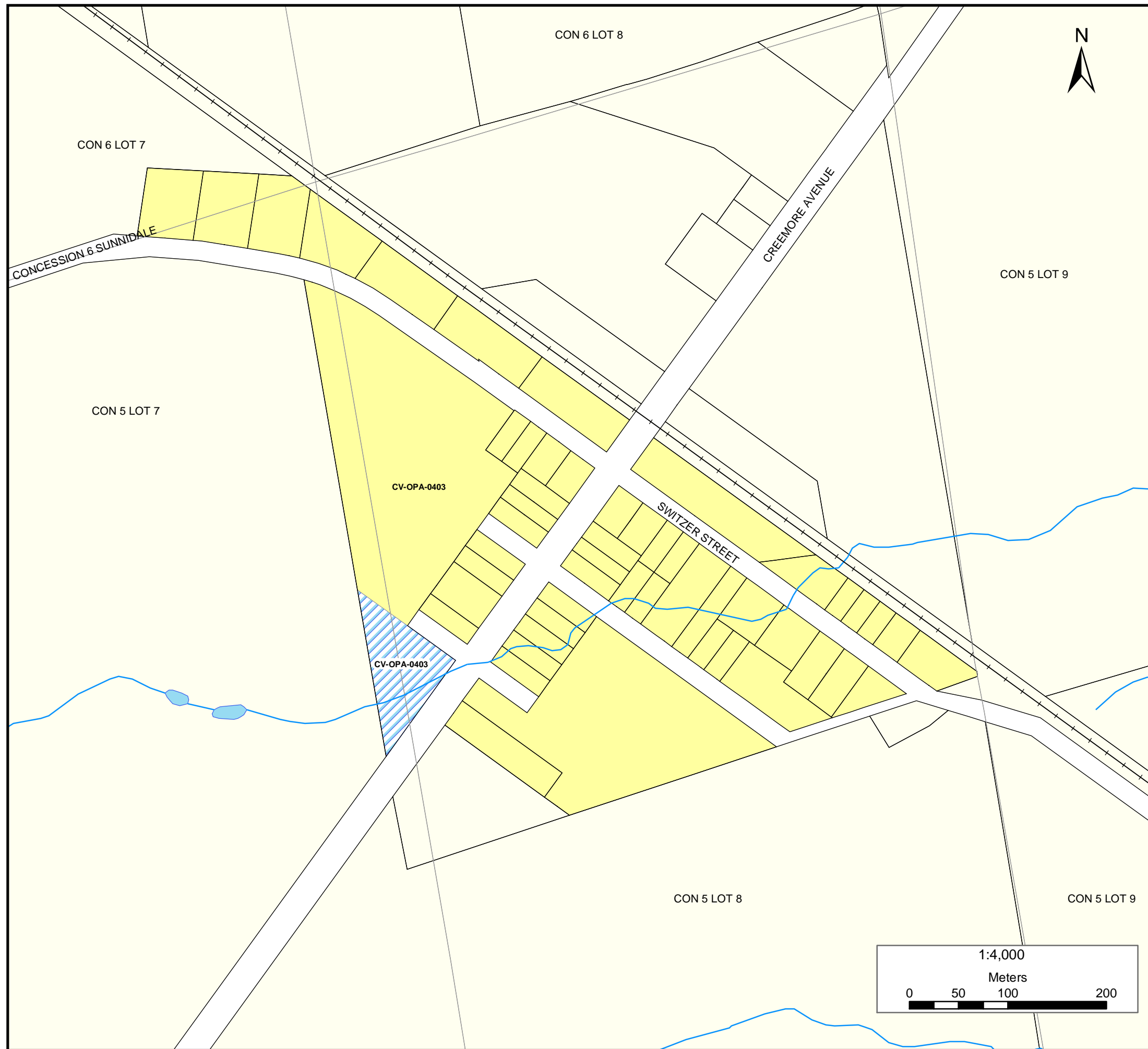

This information is provided as a public service of general information to the Corporation of the Township of Clearview. The information provided is for informational purposes only, and the Township of Clearview disclaims any responsibility for errors, omissions, or other consequences. This is not a plan of survey.

This map is published in whole or in part, may not be reproduced without the written authority from the County of Simcoe.
Copyright County of Simcoe
Land Information Network Cooperative © LINC 2004
Produced in part under license from the County of Barrie & Orillia and the County of Ministry of Natural Resources.
Copyright © Queens Printer 2004
This map is not a legal survey. For more information call (705) 726-9300 or visit www.county.simcoe.ca